

# EMPEROR ultimate rack technology

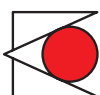

**finite elemente**  
first class audio products

# EMPEROR ultimate rack technology

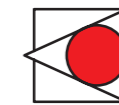

**finite elemente**  
first class audio products



## EMPEROR ultimate rack technology

Supreme sound experience and cutting-edge technology form a unique combination in the EMPEROR® series. With its clear lines and the individuality offered by the design variants the EMPEROR® can be perfectly integrated into every living environment. Its technological qualities are discreetly in the background, allowing room for emotion and musicality at an unprecedented level.

## Features

- ActiveVibeControl® for excellent performance and musicality
- ALPORAS® aluminium foam for effective energy and sound absorption
- Ceramic Ball Coupling® for optimum stability and vibration deflection
- Modular design for maximum flexibility
- Lacquers and wood veneers (matt + high-gloss)

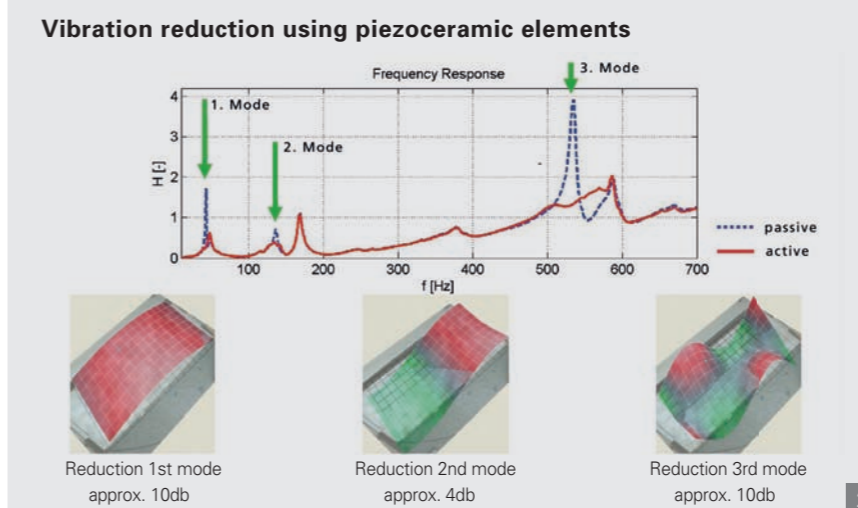
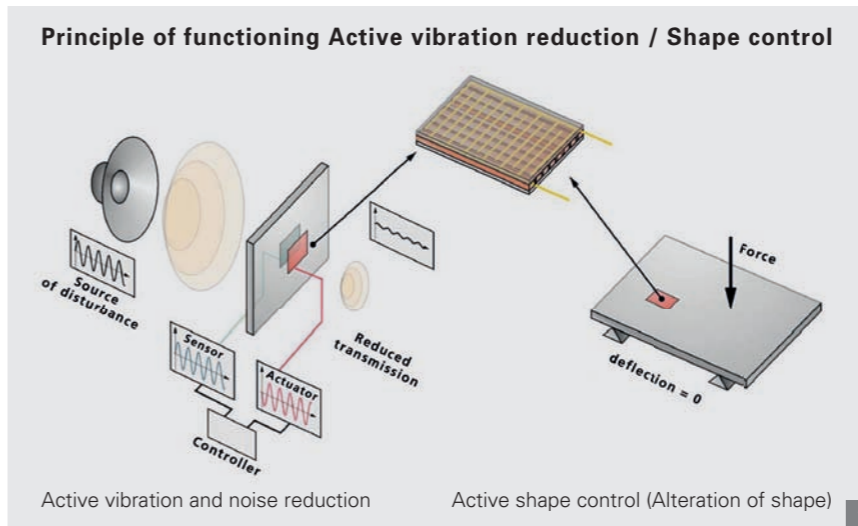

**Identification of modes / Application of piezoceramic elements**  
(i.e. component shelf of series 1250)

**ALPORAS® aluminium foam for component shelving in sandwich design**

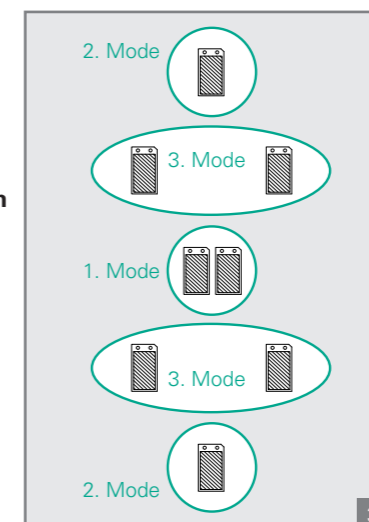

## ActiveVibeControl®

ActiveVibeControl® eliminates sound-influencing vibrations by using piezoceramic elements in the component shelves of the EMPEROR® rack system. Developed by Fraunhofer LBF in Darmstadt, Germany, and used exclusively by finite elemente in the audio furniture field, this technology offers optimum installation conditions for high-quality audio components.

The active vibration reduction is based on ad-aptronic elements that identify vibrations and counteract these in a controlled fashion by introducing a counter-vibration. This is possible using piezoceramic elements integrated into the component shelves and used there both sensorially and operatively. As sensory elements they detect sound-influencing vibrations that are signalled to a controller, where the interference is evaluated and a signal is computed for active attenuation. This signal is sent to the piezoceramic element and integrated into the component shelf. This causes specific counteraction to the vibration. In this way efficient attenuation or eradication of vibrations can be achieved by the active element (Fig. 1).

The optimum effect of the ActiveVibeControl® technology is based on ALPORAS® aluminium foam for the component shelving in sandwich design. Outstanding homogeneity and extremely low weight combined with high specific rigidity and excellent energy absorption are the major features of this high-tech material. State-of-the-art laser-measuring technology allows exact identification of problematic frequency modes within the component shelves and the corresponding positioning of the piezoceramic elements. Up to 10 dB vibration reduction can be achieved, for example with the component shelf of the 1250 Series (Figs. 2 and 3).



## Series 600

# EMPEROR ultimate rack technology

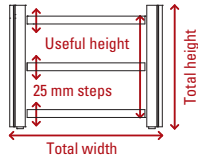

Load-bearing capacity  
per shelf: **120 kg**

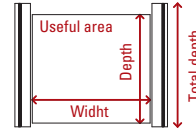

### Variants

Type	Series	Useful height	Number of shelves				
EMP	600	550	1	2	3		
		750	1	2	3	4	
		950	1	2	3	4	5

### Example Ordercode:

EMP	600	750	3
-----	-----	-----	---

### Overall dimensions

Total height	Total width	Total depth	Useful area Width and depth
660	820	660	600 x 550
860			
1060			

- Height adjustment of shelves is in 25 mm steps
- In racks with one shelf a transverse strut is used at the bottom
- All dimensions in mm

## Series 800

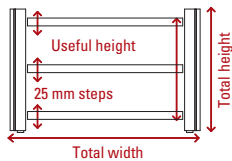

Load-bearing capacity  
per shelf: **120 kg**

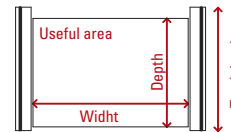

### Variants

Type	Series	Useful height	Number of shelves				
EMP	800	550	1	2	3		
		750	1	2	3	4	
		950	1	2	3	4	5

### Example Ordercode:

EMP	800	950	5
-----	-----	-----	---

### Overall dimensions

Total height	Total width	Total depth	Useful area Width and depth
660	1020	660	800 x 550
860			
1060			

- Height adjustment of shelves is in 25 mm steps
- In racks with one shelf a transverse strut is used at the bottom
- All dimensions in mm

## Series 1250

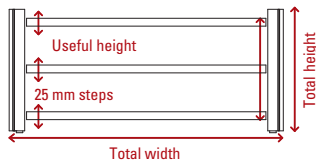

Load-bearing capacity  
per shelf: **120 kg**



### Variants

Type	Series	Useful height	Number of shelves				
EMP	1250	550	1	2	3		
		750	1	2	3	4	
		950	1	2	3	4	5

### Example Ordercode:

EMP	1250	550	2
-----	------	-----	---

### Overall dimensions

Total height	Total width	Total depth	Useful area Width and depth
660	1470	660	1250 x 550
860			
1060			

- Height adjustment of shelves is in 25 mm steps
- In racks with one shelf a transverse strut is used at the bottom
- All dimensions in mm

## Finish

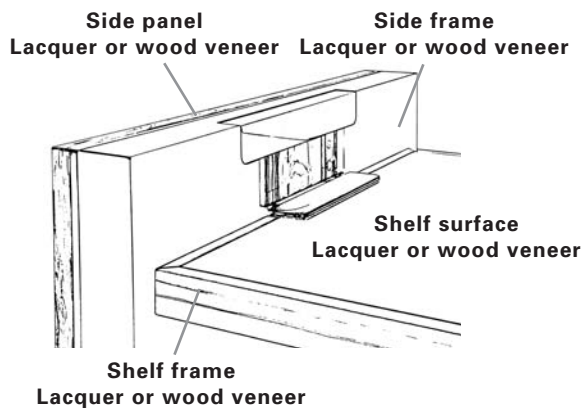

## Examples **Other lacquers and wood veneers available!**

Lacquer / Lacquer



Lacquer / Wood veneer



Lacquer / Wood veneer



Wood veneer / Wood veneer

