

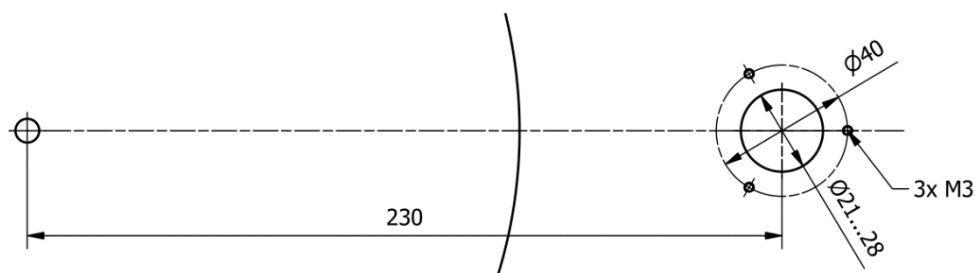

EMT 909-HI Tonearm Datasheet

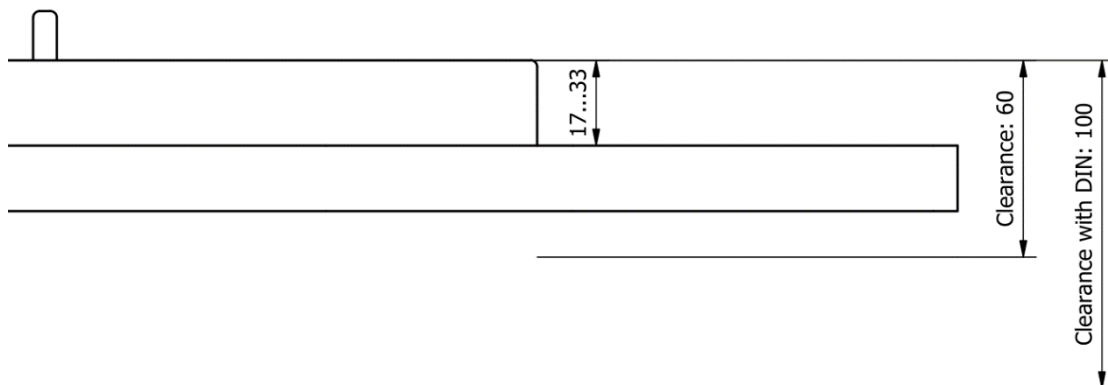

Hi-end 9 inch tonearm			
High-precision bearing technology with advanced tension compensating mechanism			
Effective length:	246.75mm	Effective mass:	10.2g
Offset angle:	22.25°	Overhang:	16.75mm
Outer null point:	120.9mm	Inner null point:	66.04mm
Connection:	Hi-fi ½ inch	Cartridge weight:	10...25g
Output:	Wire outlet 20cm	Option DIN:	5-pin DIN outlet





EMT 909 Tonearm Datasheet



Professional 9 inch tonearm for EMT Tondose			
High-precision bearing technology with advanced tension compensating mechanism			
Effective length:	246.75mm	Effective mass:	10.3g
Offset angle:	22.25°	Overhang:	16.75mm
Outer null point:	120.9mm	Inner null point:	66.04mm
Connection:	EMT Tondose	Option INT:	Ortofon A compatible
Output:	Wire outlet 20cm	Option DIN:	5-pin DIN outlet

